

# Cut-to-Length Heating Cable

## *Industrial and Commercial Self-Regulating Heating Cable*

Premium cut-to-length, self-regulating heating cable solutions designed for commercial and industrial applications. Perfect for standard and hazardous locations, as well as roof and gutter de-icing, these cables are paired with dependable power connection kits for optimal performance..



See more product information, photos, technical documents, and more



## General Heater Specifications

<b>Buss wire</b>	16 AWG nickel coated copper
<b>Conductive core</b>	Self-regulating/conductive polymer
<b>Inner jacket</b>	Modified Polyolefin
<b>Metallic overshield/braid</b>	Tinned copper or stainless steel
<b>Outer jacket</b>	Modified Polyolefin or Fluoropolymer
<b>Watts per foot/meter</b>	3 - 30 W/ft @ 50°F (10 - 98 W/m @ 10°C)
<b>Voltage</b>	110 - 120 Vac or 208 - 277 Vac
<b>T Rating</b>	T Rating T-6, T-5, T3, T-2C
<b>Approvals</b>	CSA, FM, UL
<b>Environmental use(s)</b>	<ul style="list-style-type: none"> <li>• Ordinary areas</li> <li>• Div. 1/ 2 hazardous locations</li> <li>• Corrosive environments</li> <li>• Roof and gutter</li> </ul>
<b>Reel length</b>	Up to 1000 feet
<b>Water resistant jacket</b>	Yes
<b>Flame retardant jacket</b>	Yes
<b>Can be overlapped</b>	Yes
<b>Applications</b>	<ul style="list-style-type: none"> <li>• Freeze protection of pipes</li> <li>• Chilled water and plumbing pipes</li> <li>• Sump pump discharge pipes</li> <li>• Exposed P-traps</li> <li>• Cooling towers</li> <li>• Vessel freeze protection</li> <li>• Fluid flow and viscosity maintenance</li> <li>• Process temperature maintenance</li> <li>• Roof and gutter</li> </ul>

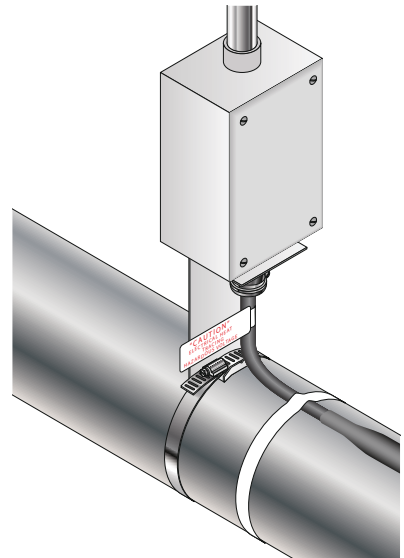
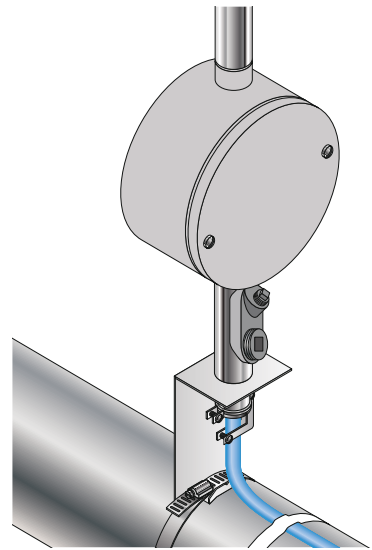

## Self-Regulating Heating Cable

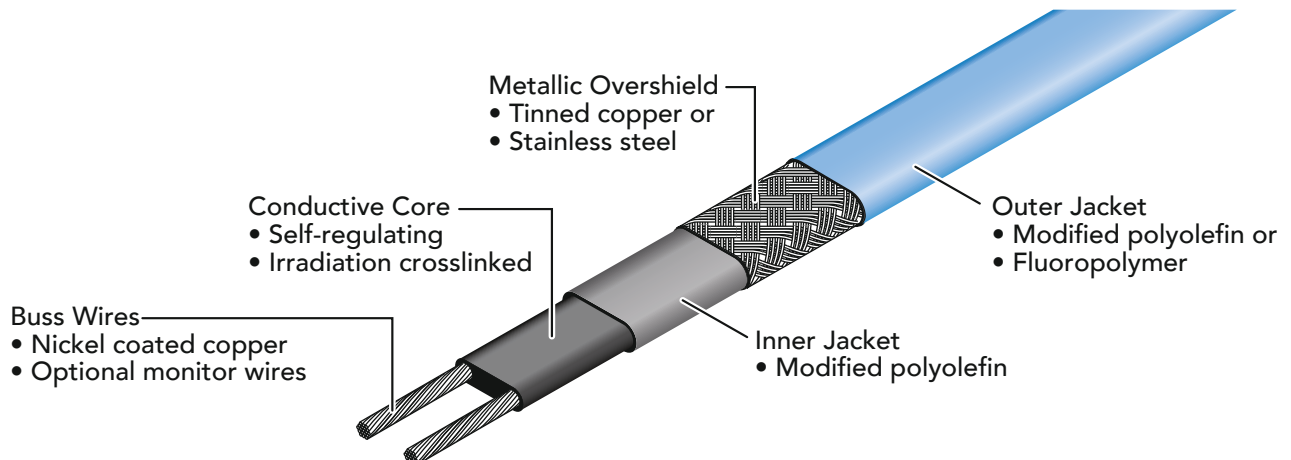



## Heating Cable Options

Heat-Line provides excellent Cut-to-Length heat cables in a large or small order requirements at very competitive prices. Offered in low, medium, and high-temperature self-regulating heating cable models, these cables can maintain temperatures up to 375°F (190°C) and withstand intermittent exposure up to 450°F (232°C) under power when the appropriate model is chosen. They are engineered for a wide range of heat tracing applications, including pipe tracing, roof and gutter de-icing, vessel tracing, temperature maintenance, and more. All heating cables are North American made by the top manufacturers providing you a reliable solution.

## Cost Savings

Many manufacturers specify their specific cables in various building plans, and Heat-Line's vast resource of products will almost always meet the building specification, providing equivalent performance with huge cost savings to the contractor. Heat-Line provides excellent Cut-to-Length heating cables in large or small order requirements at very competitive prices.

## Industrial, Commercial

Heat-Line is a sole source, high volume provider of multiple types of industrial and commercial self-regulating heating cables, components and controls. Heat-Line carries major inventories with a full understanding of the products and can provide extremely competitive pricing.

## Meets or Exceeds Most Building Specs

Heating cables are available in 120, 208, 240 and 277 volts, and wattages ranging from 3 to 30 watts per foot or 10 to 98 watts per meter. All heating cables meet or exceed most building specifications and carry regulatory approvals from CSA, FM and/or UL for ordinary and hazardous locations. Control options include: ambient and line sensing thermostats, snow melt sensors, ground fault protected thermostats and more.

## Common Applications

Heat-Line Cut-to-Length freeze protection heating cables are ideal for keeping metallic and non-metallic pipes from freezing while also providing efficient snow-melting solutions for roof and gutter applications. These heat cables provide safe, reliable heat tracing for freeze protection of pipes, valves, tanks and similar applications. In commercial construction applications, these heaters can be used on a variety of applications such as; cooling towers, chilled water and plumbing pipes, sump discharge pipes and exposed P-traps. For industrial applications, their usage can include; water treatment facilities, vessel freeze protection and safety lines. Cut-to-Length heating cables are also ideal for process temperature maintenance, pipe freeze protection, fluid flow and viscosity maintenance. Medium and high temperature industrial and commercial grade self-regulating heating cables are also available.

## Self-Regulating Technology

All Heat-Line Cut-to-Length heating cables offer the unique and advanced performance of self-regulating heating cable technology. These heaters can effectively increase heat and energy output to sections along its length which are cold and simultaneously reduce heat and energy output to sections which are warm. Even in applications where pipes are intended to be dry for short or extended periods of time, the heating cable will never over-heat or melt the pipe. These high quality heaters give you the peace of mind of reliable freeze protection without the risk. It has become an essential product for electricians, engineers and building officials overseeing commercial, industrial and municipal projects to provide safe and reliable pipe freeze protection.

# Cut-to-Length Heating Cable | Product Code Guides

## 2700 Series Low-Temperature Heating Cable Example Shown

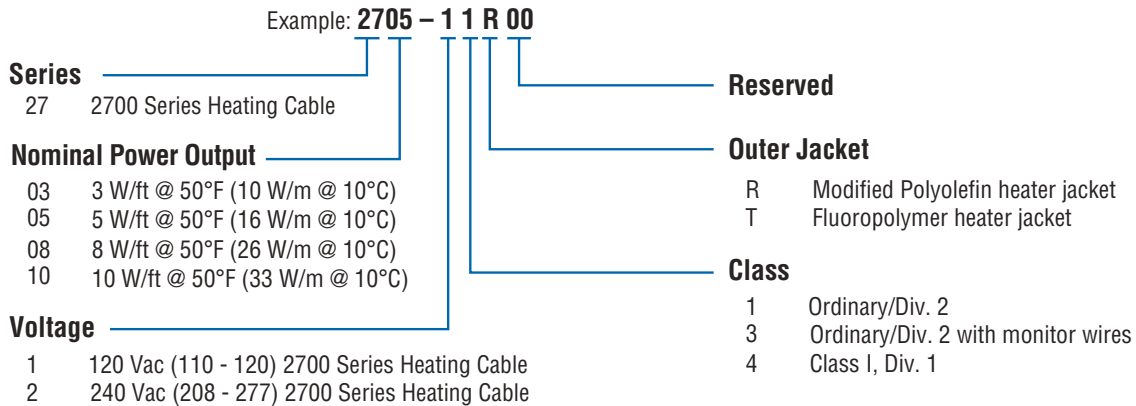

**NOTE:** The 2700 Series has a continuous maintenance temperature of 150°F (65°C) max and an intermittent exposure temperature 185°F (85°C) max. The T Rating ranges from T-6 (3, 5, 8 W/ft) to T-5 (10 W/ft).

## 2300 Series Medium-Temperature Heating Cable Example Shown

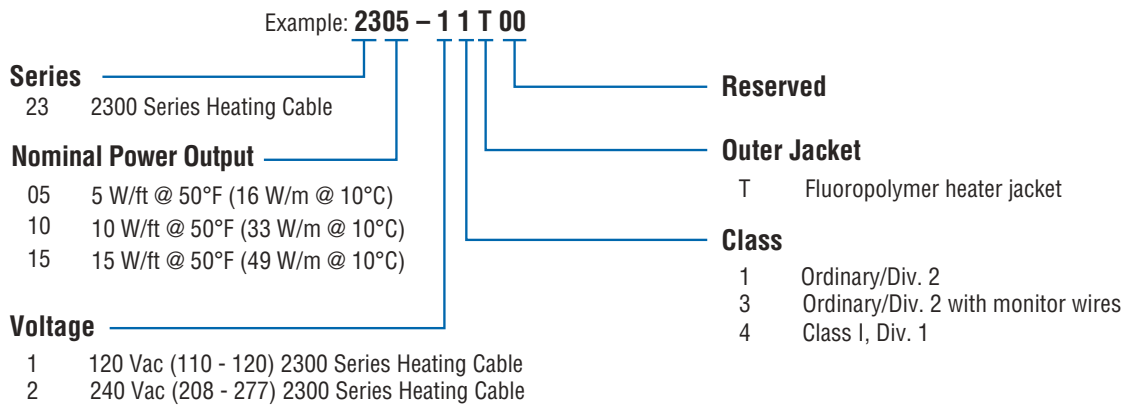

**NOTE:** The 2300 Series has a continuous maintenance temperature of 250°F (120°C) max and an intermittent exposure temperature 366°F (185°C) max, with a T Rating of T-3.

## 2000 Series High-Temperature Heating Cable Example Shown

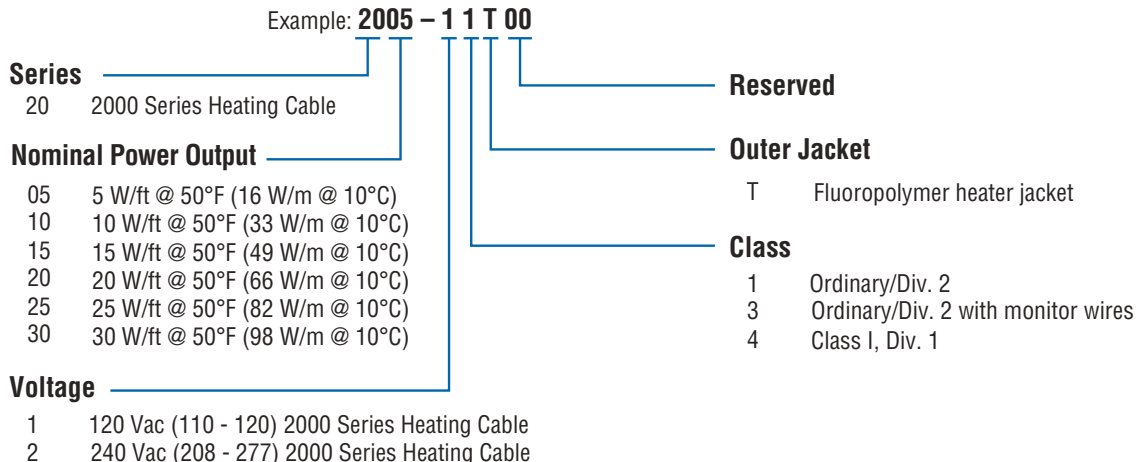

**NOTE:** The 2000 Series has a continuous maintenance temperature of 375°F (190°C) max and an intermittent exposure temperature 450°F (232°C) max. The T Rating ranges from T-2C.

## Electrical Connection Kits | Product Codes

<b>1548-40000</b>	2700 Series power/tee splice and end seal connection kit, pipe trace, FM hazardous and non-hazardous
<b>1548-4000C</b>	2700 Series power and end seal connection kit, pipe trace, CSA non-hazardous
<b>1548-4010C</b>	2700/2300 Series power and end seal connection kit, pipe trace, CSA hazardous and non-hazardous
<b>1548-40PTJ</b>	2700/2300 Series power connection kit, FM hazardous and non-hazardous
<b>1548-40RGP</b>	2700 Series power and end seal kit, roof and gutter, CSA, UL
<b>SRHC-ES</b>	2700/2300 Series end seal kit, pipe trace, CSA/FM hazardous and non-hazardous
<b>HTLN-GFC-KIT-120</b>	2700 Series 120V plug-in GFEP power and end seal kit, pipe trace and roof and gutter, CSA non-hazardous
<b>HTLN-GFC-KIT-240</b>	2700 Series 240V plug-in GFEP power and end seal kit, pipe trace and roof and gutter, CSA non-hazardous
<b>1548-41000</b>	2300 Series power/tee splice and end seal connection kit, pipe trace, FM hazardous and non-hazardous
<b>1548-81HOE</b>	2000 Series end seal kit, pipe trace, FM hazardous and non-hazardous
<b>1548-81000</b>	2000 Series power/tee splice and end seal connection kit, pipe trace, FM hazardous and non-hazardous
<b>1548-81HTJ</b>	2000 Series power connection kit, FM hazardous and non-hazardous

For specific approval information on the above connection kits contact Heat-Line

Note: Other heating cables and electrical connection kits available by special request.

## Cut-to-Length Heating Cable | Accessories

<b>TIMER-CS</b>	120/240V hard wire timer (CS)	<b>GIT-1</b>	Gutter ice sensor (requires controller, PD-PRO or GF-PRO)
<b>GFA-STAT</b>	120/240V hard wire thermostat GFEP (CS)	<b>SNOW-OWL</b>	Aerial snow sensor (requires controller, PD-PRO or GF-PRO)
<b>GPT-130</b>	120/240V hard wire thermostat GFEP (CS)	<b>LCD-8</b>	120/240V aerial snow switch controller
<b>MA-10</b>	120/240V GFCI/ELCI (CS)	<b>PD-PRO</b>	120/240V snow/ice controller
<b>PGFS-23105-98</b>	30A 240V 1PH Permanent ELCI Auto Reset 10mA Trip Level	<b>GF-PRO</b>	120/240V snow/ice controller with GFEP
<b>PGFS-93105-98</b>	30A 208V 1PH Permanent ELCI Auto Reset 10mA Trip Level	<b>DS-8C-CONTROLLER</b>	120/240V rain/snow sensor controller with remote 10' Sensor
<b>PGFS-33105-98</b>	30A 120/ 240V, 1PH Permanent ELCI, Auto Reset, 10mA Trip Level	<b>DS-8C-EX-50</b>	Rain/snow sensor extension 50' kit for DS-8C-CONTROLLER
<b>PLD-CG</b>	Cable guards/protectors (pkg of 4, 6 in each)	<b>CDP-2-RC-DP</b>	Indoor snow sensor control/display panel for DS-8C-CONTROLLER
<b>PLD-RC</b>	Roof clips (package of 10)	<b>PYROBOX-1-CONTROL</b>	240V snow/ice controller with GFEP
<b>PLD-RC-S5-SR</b>	Roof clip S-5-5 only (package of 10)	<b>PYRO-SENSE-GUTTER</b>	Gutter ice sensor (requires controller, PYROBOX-1-CONTROL)
<b>PLD-RC-S5-SRU</b>	Roof clip S5 universal (package of 10)	<b>PYRO-SENSE-AERIAL</b>	Aerial snow sensor (requires controller, PYROBOX-1-CONTROL)
<b>PLD-RC-GC</b>	Roof grip clip for roof shingle material up to 3/8" thick	<b>PYRO-SENSE-SB</b>	Snow sensor wall mounted adjustable metal arm (requires controller, PYRO-SENSE-AERIAL)
<b>PLD-CLAMP-S5-S</b>	Roof mounting clamp S-5-S c/w machine bolt	<b>HL-SMC-2C3P-GFEP</b>	GFEP heat trace contactor panel 2 3-pole contactors (external control required)
<b>PLD-RDK</b>	Downspout hanger kit	<b>HL-SMC-4C3P-GFEP</b>	GFEP heat trace contactor panel 4 3-pole contactors (external control required)
<b>CLOTH-TAPE-LT</b>	2700 Series fiberglass tape, 130C rated, 60 yards or 180ft per roll 1/2" wide	<b>HL-SMC-2C3P</b>	Non-GFEP heat trace contactor panel 2 3-pole contactors (external control required)
<b>CLOTH-TAPE-HT</b>	2300/ 2000 Series fiberglass tape, 130C rated, 36 yards or 108ft per roll 1/2" wide	<b>HL-SMC-4C3P</b>	Non-GFEP heat trace contactor panel 4 3-pole contactors (external control required)
<b>FOIL-TAPE</b>	All weather aluminum foil tape (150 ft)		
<b>1660-13A11</b>	120/240V Line sensing thermostat, 25-325F, NEMA 4X Ordinar		
<b>1660-13A12</b>	120/240V Line sensing thermostat, 25-325F, FM Class 1 Div 1		
<b>1660-18911</b>	120/240V ambient sensing thermostat, Ordinary Location		

## Cut-to-Length | Roof Sample Application

Shingle / Shake Roof with Gutters and Downspouts with HTLN-GFC-KIT Electrical Connection Kit Example Shown

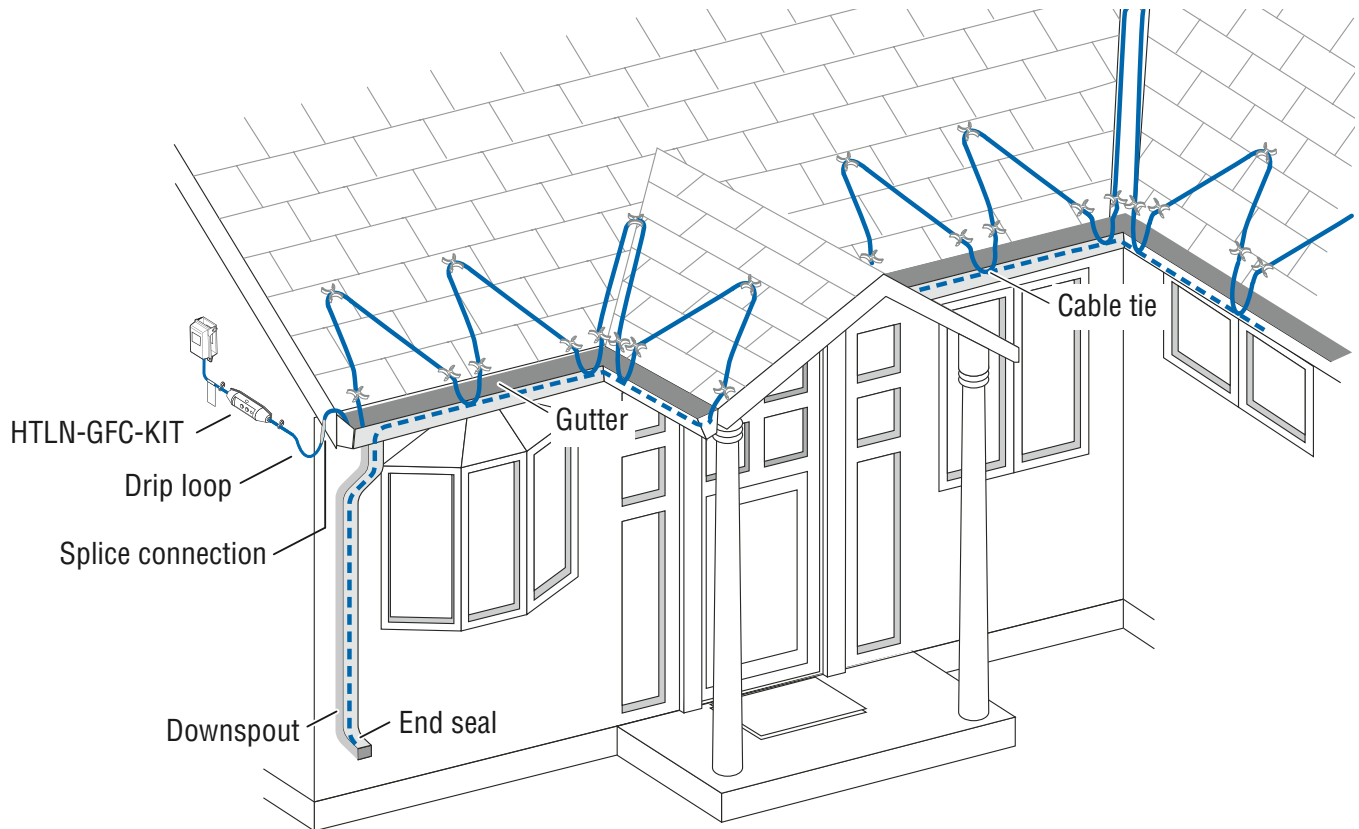

## Cut-to-Length | Pipe Sample Application

Single Run Installation with HTLN-GFC-KIT Electrical Connection Kit Example Shown

